



Pathlight Light

These pathlights are the ultimate in heavy duty landscape lighting. Made of cast brass, they are larger than other our pathlights. The multi-louver design uses incandescent, metal halide, xenon, and omnidirectional LED lamps. The single-louver design uses MR16 LEDs and integrated LED light engines.

IEC 62717 LED-modules for general lighting – Performance requirements
IEC 62722-2-1 Particular requirements for LED luminaires

High Lumen Efficacy 100lm/W
Body - Cast brass shade, louvers, and base assembly
Lens - Industry standard vapor-proof, prismatic, tempered glass
Glowing Wire Test - 850°
Temperature - ta=-20 °C ~ ta max=65 °C
Class - I

FIELDS OF APPLICATION
Outdoor Gardens, Parks, Pathways,

Model --- **R47**

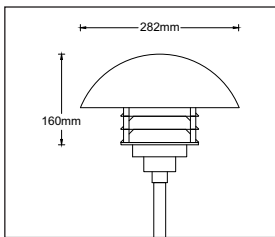

- A** - Ø282 X H160mm - Stem 400
- B** - Ø282 X H160mm - Stem 500
- C** - Ø282 X H160mm - Stem 600

Default Available

3R47-BR-30-180-0-A

Product Assistant Chart

R47 X X X X X

Size — A — B — C —

Driver 0 1 2 3 4
On/Off Dali Dimmable Phase Dimming 1-10

Beam Angle 180°

Kelvin 27 28 30
2700K 2800K 3000K

Finishing W G B SL RU
White Dark Grey Black Silver Rust

Wattage — 3 — 5 — 8 — 11 —

Lighting Customization Solution can offer you modifications for environment with higher options as a customized product.

IP 65 IK 10 LED / GU 5.3 / G4 McA Step 3 12V / 220-230V

Relative spectral perception of brightness and melanopic effect
Effect as a percentage

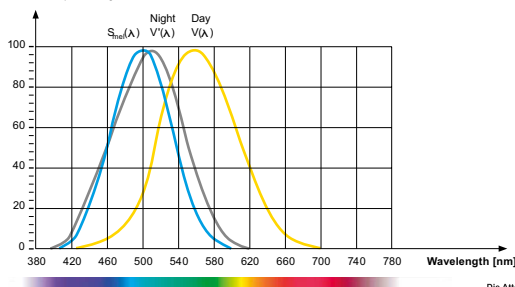

Explanation of the three curves:
V(A) = Perception of brightness, daytime seeing with the cones
V(A) = Night-time seeing with the rods
S_{mel}(A) = Melatonin suppression with the photosensitive ganglion cells

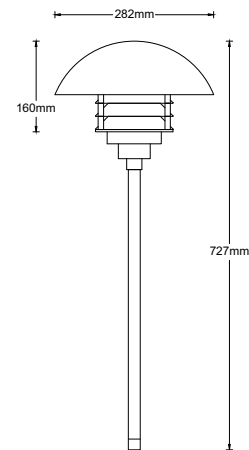

LED life time		Operating time 1.000 h										
Lamp Lumen Maintenance Factor		1	10	20	30	40	50	60	70	80	90	100
Lamp Survival Factor		1	1	1	1	1	1	1	1	0.99	0.99	0.99
L80	50.000 h	LLMF	1	0.96	0.92	0.88	0.84	0.80	0.76	0.72	0.68	0.64
		LSF	1	1	1	1	1	1	0.99	0.99	0.99	0.98
L80	100.000 h	LLMF	1	0.98	0.96	0.94	0.92	0.90	0.88	0.86	0.84	0.82
		LSF	1	1	1	1	1	1	1	0.99	0.99	0.99



LED



series wiring

