



Hand Rail Luminaires

Simple and easy appearance, in line with contemporary aesthetic concept. The product has the structure and appearance design patent. The lamp body adopts high-pressure cast aluminum and aluminum alloy, the surface is coated with outdoor used powder, double anti-corrosion to extend service life. This lawn lamp series uses LED. High efficiency constant current driver, ensure the light source is maximum used.

IEC 62717 LED-modules for general lighting – Performance requirements
IEC 62722-2-1 Particular requirements for LED luminaires

High Lumen Efficacy 85lm/W
Body - Stainless Steel and Aluminum
Glowing Wire Test - 650°
Temperature - $t_a=20\text{ }^\circ\text{C} \sim t_a \text{ max}=50\text{ }^\circ\text{C}$
Class - III

FIELDS OF APPLICATION

Handrail

Model ----- K98

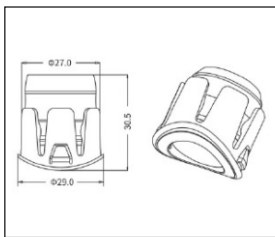

Default Available

2K98-W-27-60-0-A



Product Assistant Chart

K98 X X X X X							
Size	A — B						
Driver	0	1	2	3	4		
	On/Off	Dali	Dimmable	Phase Dimming	1-10		
Beam Angle	26°		60°		80°		
Kelvin	27		30		40		50
	2700K		3000K		4000K		5000K
Finishing	60		65		R		
	6000K		6500K		RGB		
Finishing	W		SS				
	White		Stainless Steel				
Wattage	1.5W		02W				

A - Ø29 X H26.7mm

B - Ø29 X H30.5mm

Lighting Customization Solution can offer you modifications for environment with higher options as a customized product.

IP 67 500mA DC3V /
DC12V / DC24V

Relative spectral perception of brightness and melanopic effect

Effect as a percentage

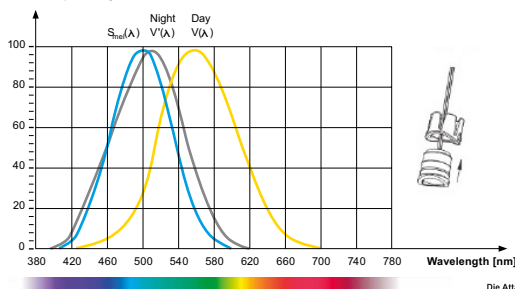

Explanation of the three curves:
V(A) = Perception of brightness, daytime seeing with the cones
V(A) = Night-time seeing with the rods
S_{mel}(A) = Melatonin suppression with the photosensitive ganglion cells

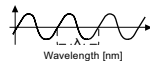

Installation

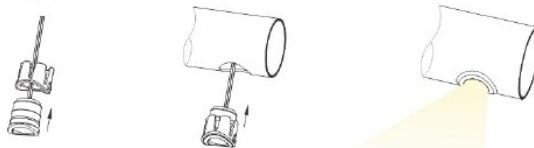

Application



LED life time		Operating time 1.000 h										
Lamp Lumen Maintenance Factor	Lamp Survival Factor	1	10	20	30	40	50	60	70	80	90	100
L80	50.000 h	LLMF	1	0.96	0.92	0.88	0.84	0.80	0.76	0.72	0.68	0.64
		LSF	1	1	1	1	1	1	0.99	0.99	0.99	0.98
L80	100.000 h	LLMF	1	0.98	0.96	0.94	0.92	0.90	0.88	0.86	0.84	0.82
		LSF	1	1	1	1	1	1	1	0.99	0.99	0.99



LED



series wiring



CE



LM-80

